

GPSW050 Ground Screw Connection

Inadequate grounding can make the operator susceptible to damage from power surge from lightning. Check the ground connections on the operator housing.

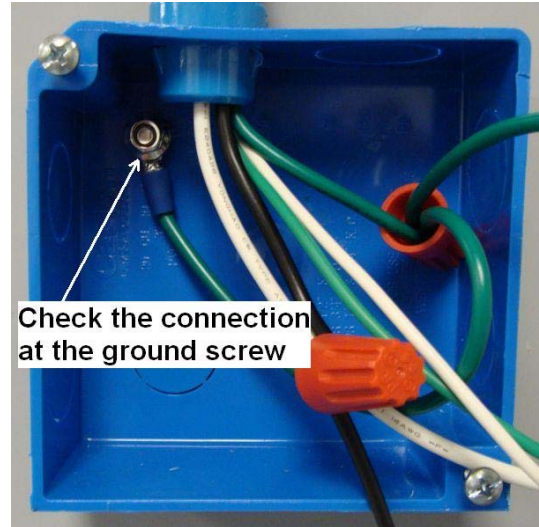

Check under the head of the ground screw inside the cabinet to ensure that the head of the screw is making good contact with the bare steel housing.

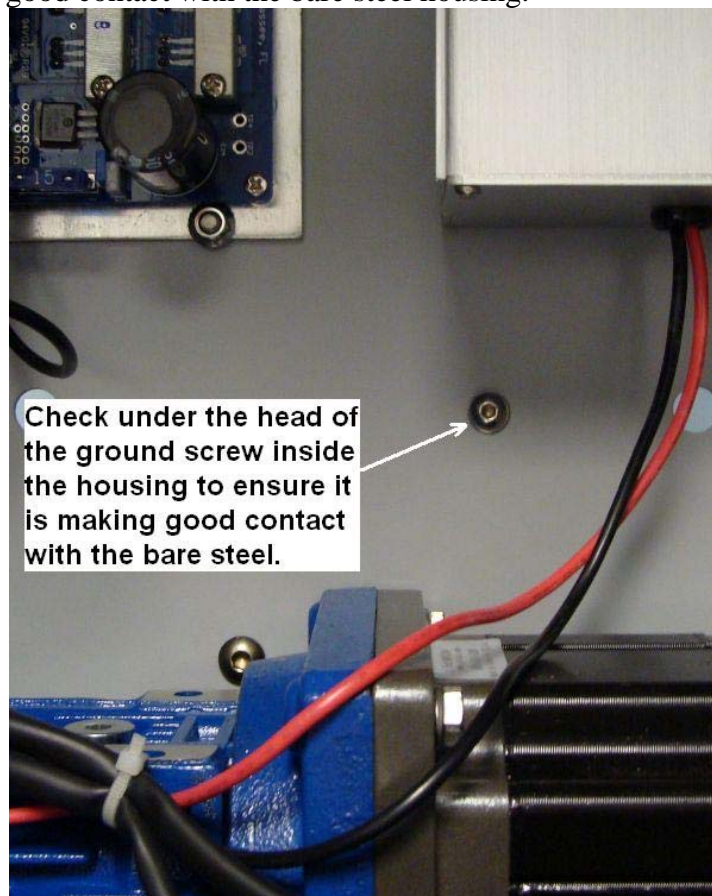

If the head of the screw is resting on top of the powder coating, scrape off the powder coating to expose the bare steel. The head of the ground screw must be in contact with the bare steel in order to provide an adequate ground.

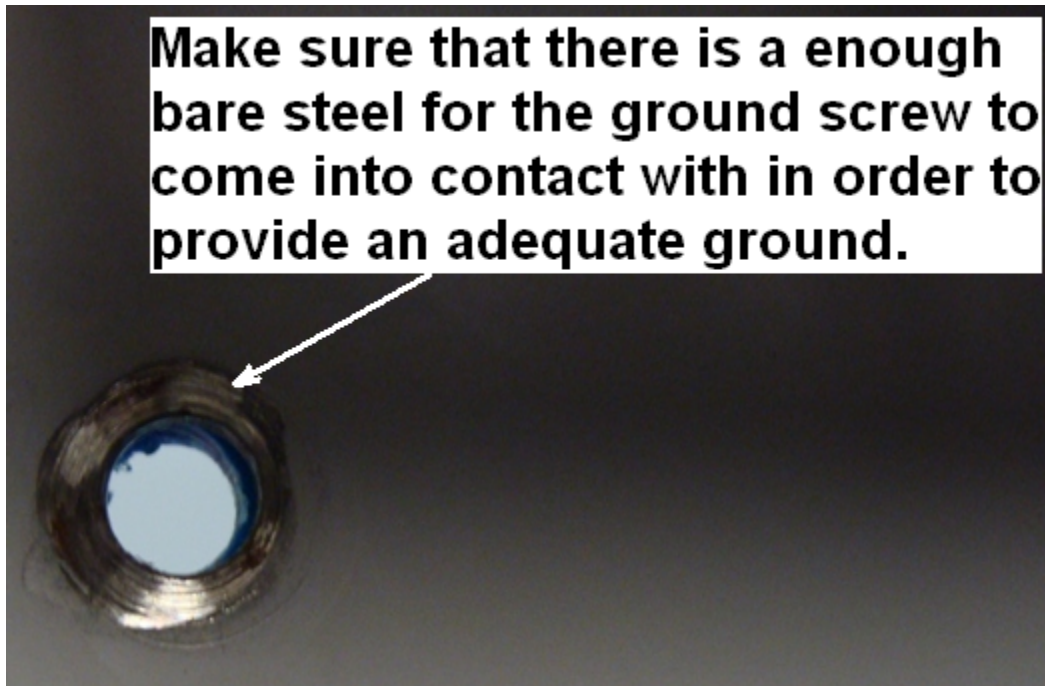

You will also want to add a surge protection module on the incoming AC line. This will help protect the operator from spikes and surges coming from dirty power and lightning.